

READ ALL INSTRUCTIONS BEFORE ASSEMBLY AND USE OF CHAIR.  
KEEP INSTRUCTIONS FOR FUTURE USE.

**joovy®**

# Hook Instruction Manual 21X Series

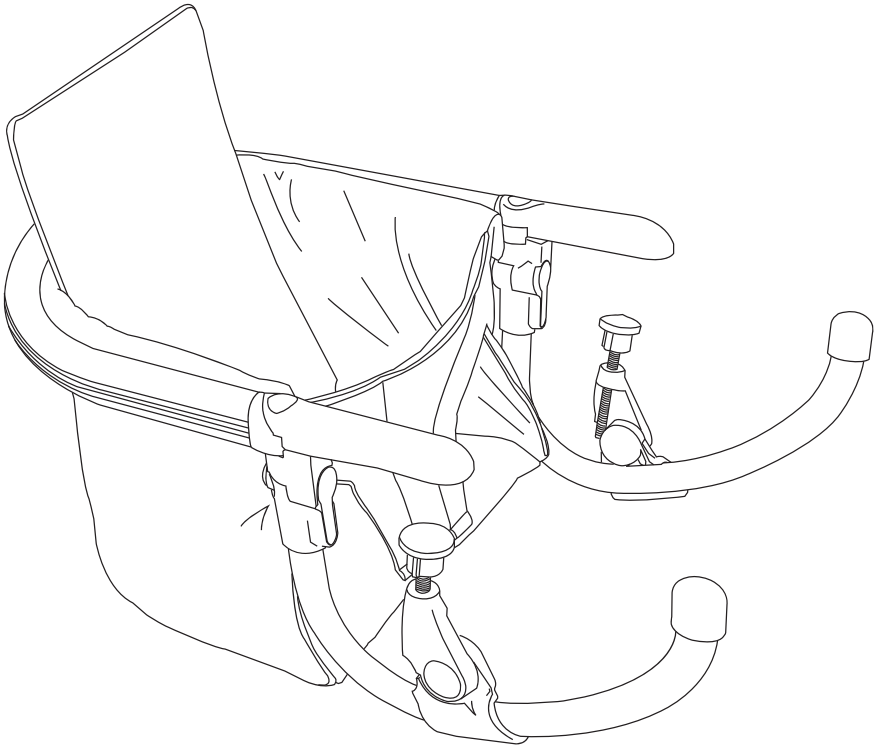



# WARNINGS

**Please read this instruction manual completely before using this product. Failure to follow all warnings and instructions could result in serious injury or death. Keep these instructions for future reference.**

- Prevent serious injury or death from falls or sliding out.
- Always secure child using the restraint system.
- Never leave child unattended. Always keep child in view while in hook-on chair.
- Do not use on a glass table top, loose table top, single pedestal table, card table, table leaf, or with table cloths or placemats.
- Check stability of table before and after seating child.
- Recommended only for children capable of sitting upright unassisted.
- Do not place ordinary chair under this hook-on chair or position this hook-on chair on counters or tables that are near structures which could be used by the child to push the hook-on chair off or up from the table or counter.
- Use only for children up to 37 pounds (16.8 kg).
- Use only for tables 1 to 2 inches thick (25 to 50mm).
- Keep table and seat clean and dry to prevent slipping.
- Do not hang objects on the hook-on chair that could cause the hook-on chair to become unstable.
- Never use in any location where hanging cords can be reached by child.
- Do not attach or detach the hook-on chair when a child is in it.
- Do not use without all rubber grips attached securely to the table surface.
- Discontinue use if child, when seated in the hook-on chair, is able to move the hook-on arms on the table top.
- Do not allow other children to play near or walk under the hook-on chair while in use.
- Before removing child from hook-on chair, be sure child's legs are free from hook-on chair supports.
- Do not use the hook-on chair unless all components are correctly fitted and adjusted.
- Check your hook-on chair for any parts that may be broken, torn or missing before use and on a regular basis. Discontinue use of the hook-on chair should it malfunction, become damaged, or broken. Contact manufacturer immediately for replacement parts or service. Use only parts supplied by the manufacturer.
- Discard all packaging materials properly. Do not allow children to play with them.

**Please do not return this product to the store**

If you experience any difficulty with the assembly or use of this product, or if you have a question regarding these instructions, please contact our Customer Service Department at (877) 456-5049 between the hours of 8:30 am and 5:00 pm Central Time.

**Please Note: Styles and colors may vary**

# Assembling and Using your Hook-On Chair

**⚠ To ensure safe operation of your hook-on chair, please follow these instructions carefully.**

## Unpacking the Product

- Carefully remove hook-on chair and all parts from the box and plastic bag.
- Remove any cardboard packing materials from the product.
- Identify the parts (hook-on chair, travel bag) with the pictures in Figure 1.
- Remove all plastic coverings from any areas of the product and discard them properly. Do not allow children to play with them.

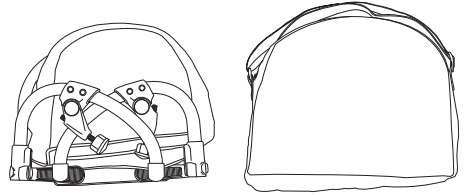

**Figure 1**

## Identify Product Components

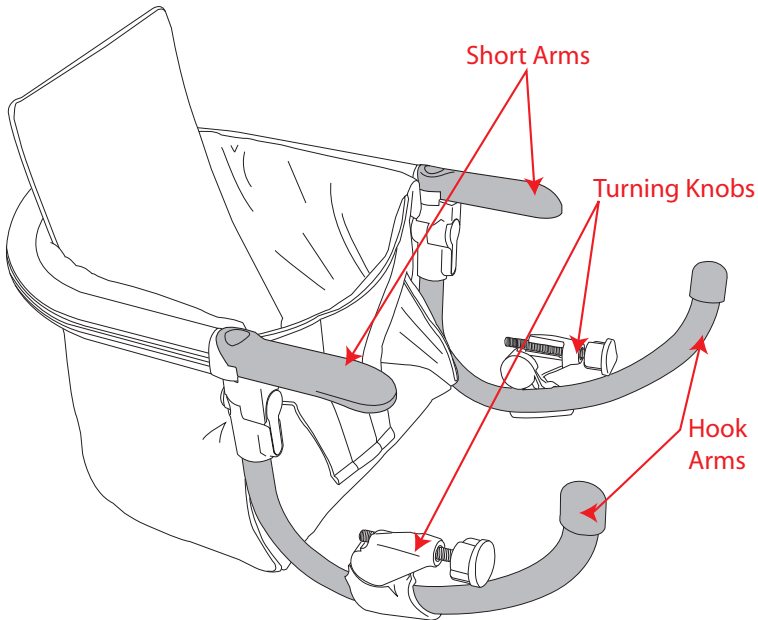

**⚠ CAUTION**

**Adult assembly is required for this product. No Tools Required.**

# Unfolding the Hook-On Chair

- Orient the folded hook-on chair upside down with the hook arms facing upwards.
- Locate the button on the outside near the top of the uppermost hook arm. While pressing the button, rotate the hook arm upward until an audible click is heard and it locks into position. See Figure 2. Repeat this procedure on the hook arm on the other side of the chair.
- Then, orient the hook-on chair with the hook arms facing downward and away from you.
- Locate the button on the top of the short arm connected to the outermost hook arm. While pressing the button, rotate the arm outward until an audible click is heard and it locks into position. See Figure 3. Repeat this procedure on the arm on the other side of the chair.
- Check to ensure that both arms are fully extended and locked into position. You should not be able to close them when they are fully locked.
- Position the backrest onto the back of the chair using the Velcro® on the backside of the backrest. See Figure 4. Push the seat down away from the U-shaped frame and you are ready for the table. See Figure 5.

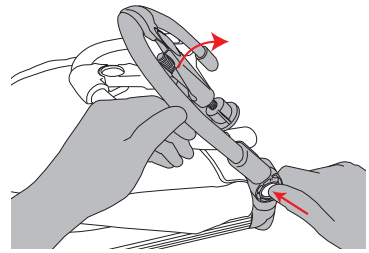

**Figure 2**

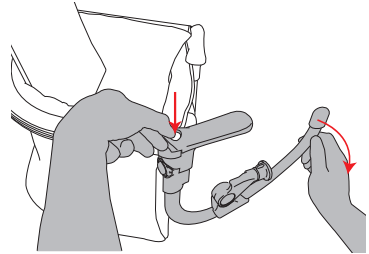

**Figure 3**

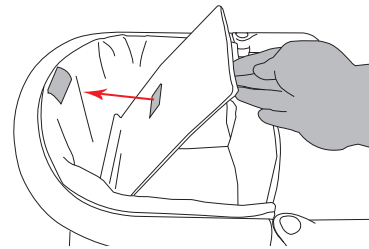

**Figure 4**

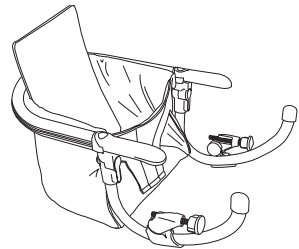

**Figure 5**

## Attaching the Hook-On Chair to the Table

- Ensure that the hook arms of the chair are fully extended and locked into position.
- Check to ensure that the turning knobs (located at the center of the hook arms) are in horizontal position away from the seat. To rotate a turning knob to the horizontal position, press the button on the lower outside portion of the mechanism and rotate the turning knob into position. Repeat for the other hook arm. See Figure 5.
- Angle the chair and position it on the table so that the short arms are on top of the table. See Figure 6. Push the chair onto the table until it cannot go any further.
- Again, locate the turning knob at the center of the hook arm. Press the button on the outside of the knob to rotate the knob into the vertical position. See Figure 7. Repeat this procedure for the other hook arm.
- Rotate the knob counter-clockwise until it is tensioned tightly to the underside of the table. See Figure 8. Repeat this procedure on the other side.
- Once the chair is securely fastened to the table, you should not be able to move it at all by pushing on it either sideways or front-to-back. There should not be any gap between the table top and the short arm. See Figure 9.

### **WARNING**

**Check the stability of the table before and after seating the child. Do not attach the hook-on chair while a child is in it.**

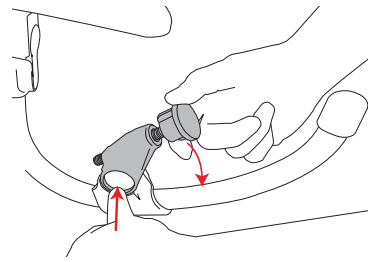

**Figure 5**

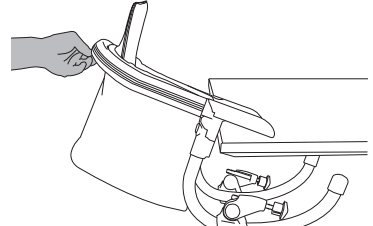

**Figure 6**

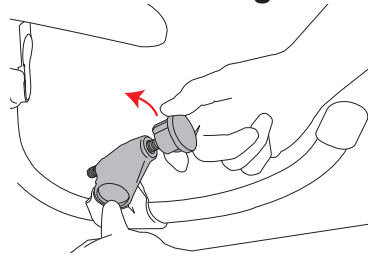

**Figure 7**

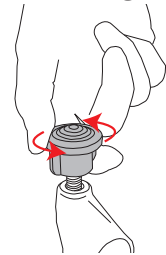

**Figure 8**

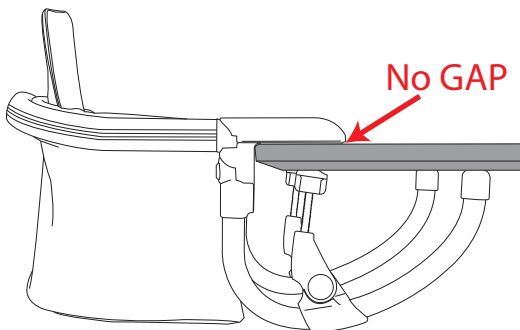

**Figure 9**

## Securing the Child in the Seat

- Unlatch the waist/crotch buckle by pressing in on the buckle button and removing the male ends of each buckle. See Figure 11.
- Carefully place the child in the hook-on chair and position the crotch strap between the child's legs.
- Bring the seat belt around the child's waist and insert the male ends of the waist buckle into the female buckle. Ensure that they snap into place. See Figure 12.
- Tighten the waist and crotch belt using the sliding adjusters to be snug around the child.

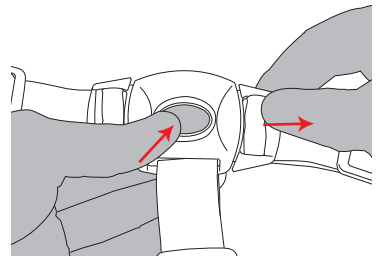

**Figure 11**

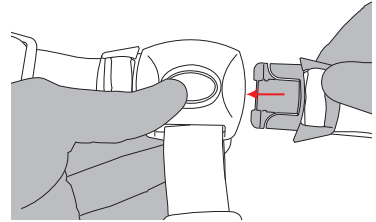

**Figure 12**

## **WARNING**

**Prevent serious injury from falls or sliding out. Always secure child with the restraints. Never leave child unattended.**

## Detaching the Hook-On Chair from the Table

- Remove child from the chair.
- Rotate the turning knob clockwise to loosen it from the table.
- Press the button on the outside of the turning knob and rotate the knob into the horizontal position. Repeat this procedure on the other side.
- Angle the chair and pull it away from the table until it is free.

## **WARNING**

**Do not detach the hook-on chair while a child is in it. Before removing child from hook-on chair, be sure the child's legs are free from hook-on chair supports.**

## Folding the Hook-On Chair

- Remove the chair from the table.
- Detach the Velcro® on the backrest and fold towards front of the chair.
- Press the button on the top of either short arm and rotate the hook arm sideways towards the chair until an audible click is heard. See Figure 13. Repeat this procedure on the other arm.
- Orient the hook-on chair upside down with the hook arms facing upwards.
- Locate the button on the outside top of the innermost hook arm. Press the button and rotate the hook arm toward the chair until an audible click is heard and it locks into place. See Figure 14. Repeat this procedure on the other arm.
- Open the zipper on the travel bag and insert the chair into the bag with the U-shaped frame at the open side of the bag. Close the zipper once the chair is completely inside the bag.
- The length of the shoulder strap on the bag can be adjusted by sliding the buckle in either direction until the strap is at the desired length.

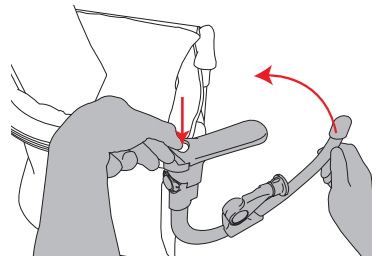

**Figure 13**

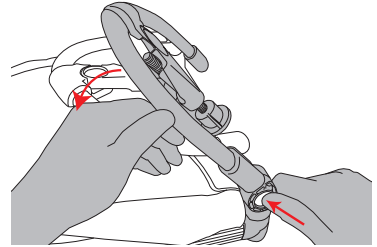

**Figure 14**

## Maintenance

All of the fittings, snaps, locks, rivets, and other hardware and plastic parts on the hook-on chair should be inspected periodically to ensure that they are secured properly and not damaged or malfunctioning. The seat belt, as well as all other fabric items and their stitching should also be inspected periodically to ensure that they are secured properly and not loose, torn or otherwise damaged. All moving parts, such as the hinges should also be checked periodically to ensure they are operating properly.

Any missing, broken, or worn components should be replaced immediately, and the hook-on chair should not be used until they are replaced. Only original manufacturer's components should be used. If needed, please contact Joovy at our toll-free phone number.

## Cleaning

The fabric material on the hook-on chair can be cleaned using mild household soap or detergent and warm water on a sponge or clean cloth. Always allow the fabric to completely air dry before using the hook-on chair.

## **SATISFACTION GUARANTEED**

**We want you to be completely satisfied with your purchase of this product. Should you experience any difficulty in assembling or using this product, or if you have any questions, please contact our Customer Service Department at (877) 456-5049 between the hours of 8:30 am and 5:00 pm Central Time.**



Joovy • 2919 Canton Street • Dallas, TX 75226 • (877) 456-5049 • Fax: (214) 761-1774  
E-mail: [customerservice@joovy.com](mailto:customerservice@joovy.com) • Website: [www.joovy.com](http://www.joovy.com)

©Joovy 2010 • Document Version 070810