

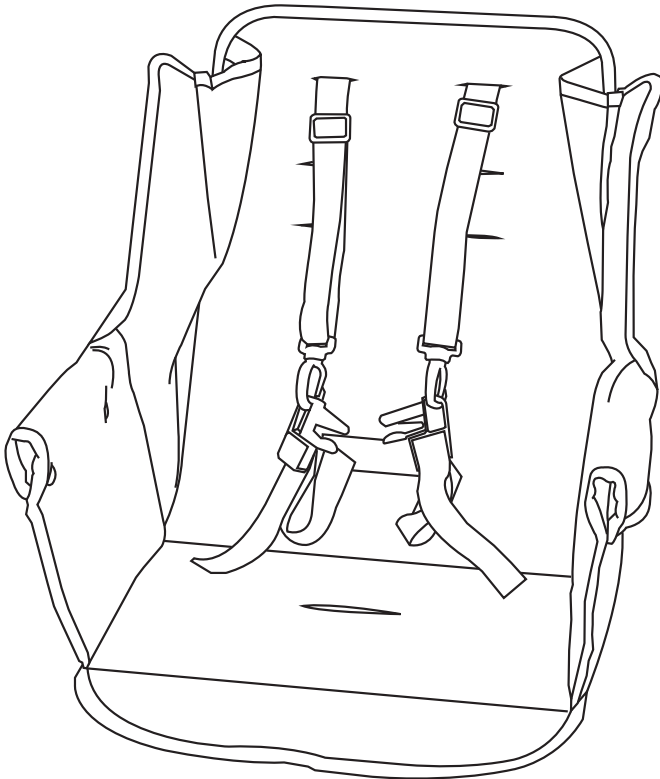

Caboose Too Rear Seat Instruction Manual

0090X & 0091X Series



WARNING

**Please read this instruction manual completely before using this product.
Keep these instructions for future reference.**

- Failure to follow these instructions could result in serious injury or death.
- Never leave child unattended.
- Avoid serious injury from falling or sliding out.
- Always use safety belts and ensure that all children are positioned according to these instructions.
- The maximum weight of the child that can be seated in this rear seat is 45 lbs.
- Use of the stroller with two children weighing more than 45 lbs. each or children totaling more than 90 lbs, will cause excessive wear and stress on the stroller and may cause a hazardous unstable condition.
- Discard all packaging materials properly. Do not allow children to play with them.
- Discontinue use of the product should it malfunction or become damaged.

Please do not return this product to the store

If you experience any difficulty with the assembly or use of this product, or if you have a question regarding these instructions, please contact our Customer Service Department at (877) 456-5049 between the hours of 8:30 am and 5:00 pm Central Time.

Please note: Styles and colors may vary.

Installing the Caboose Too Seat

1 Unpacking the Product

- Remove the seat and documents from the box. **See Figure 1.1** (not to scale). documents not shown.
- Discard all packaging materials properly including plastic coverings.
- DO NOT allow children to play with any packaging materials.

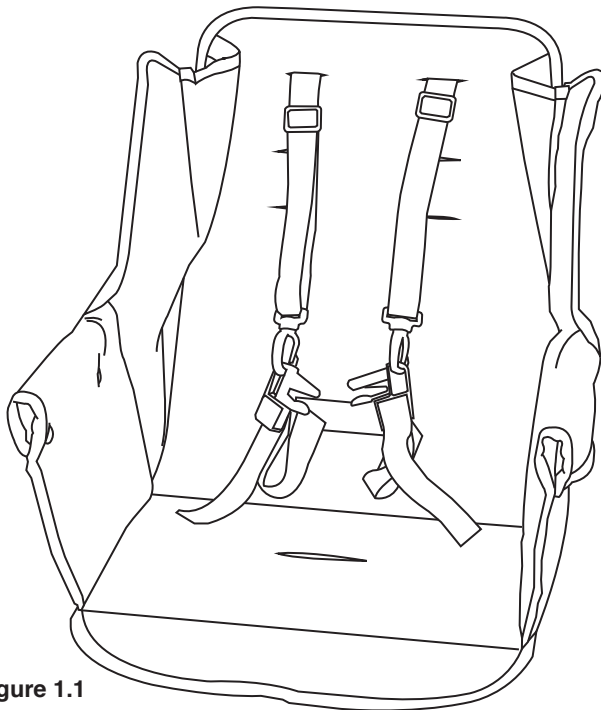

Figure 1.1

WARNING

Adult assembly is required for this product.

Tools Required (Big Caboose Only): Phillips head screwdriver.

2 Removing the Rear Bench Seat Waist Strap from Stroller

(Caboose and Caboose Ultralight Only)

- On the stroller, unsnap both waist straps from the crotch strap on the rear 3-point harness. Leave the crotch strap in place to use with the Caboose Too Rear Seat.
- To remove the waist straps, locate one end of the strap where it attaches to the front seat tube. Slide the strap through the small opening of the metal D-ring and pull the strap away from the front seat. Repeat for the other strap. **See Figure 2.1.**
- Store waist straps in a safe place for future use.

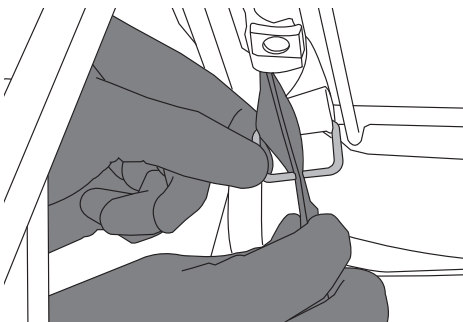

Figure 2.1

3 Removing the Rear Bench Seat Waist Strap from Stroller

(Big Caboose Only)

- On the stroller, unsnap both waist straps from the crotch strap on the rear 3-point harness. Leave the crotch strap in place to use with the Caboose Too Rear Seat.
- To remove the waist straps, locate one end of the strap where it attaches to the frame with a screw. Using a Phillips head screwdriver, unscrew the screw. Repeat for the other strap. **See Figure 3.1.**
- Store screw, washers, and waist straps in a safe place for future use.

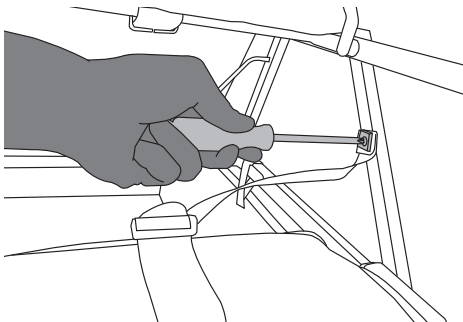

Figure 3.1

4 Attaching the Caboose Too Seat

- Place the seat fabric in position over the sliding rear bench seat so that the seat is facing toward the front of the stroller.

NOTE: It is not necessary to remove the existing fabric pad from the bench seat.

- Push the rear seat crotch strap (with the buckle) up through the slit in the Caboose Too Rear Seat. **See Figure 4.1.**
- Locate the 2 harness loops on the upper rear of the Caboose Too Rear Seat (one on each side). Snap them around the handle bar above the rear handles. **See Figure 4.2.**

NOTE: The Big Caboose does not have rear handles. Instead of snapping the loops over the rear handles, snap the loops above the upper HORIZONTAL frame bar for the Big Caboose.

- Slide the front fabric pocket, located under the front of the Caboose Too Seat, over the front of the bench seat. **See Figure 4.3. (shows the underside of the bench seat)**
- Locate the 2 long straps on the lower rear of the Caboose Too Seat (one on each side). Wrap each strap around the outside of the stroller handle bar and feed them through the loops on the back of the seat. Securely snap the straps together. **See Figure 4.4.** If necessary, pull the webbing near the male end of the buckle to tighten.

- Near the front sides of the Caboose Too Seat are 2 Velcro® straps (one on each side). Secure these straps around the lower horizontal frame bar on both sides. **See Figure 4.5.**
- Wrap the left and right armrests of the Caboose Too Seat around the upper horizontal frame (on each side). Securely snap together both snaps on each side. **See Figure 4.6.**
- Check that the seat is securely in place.

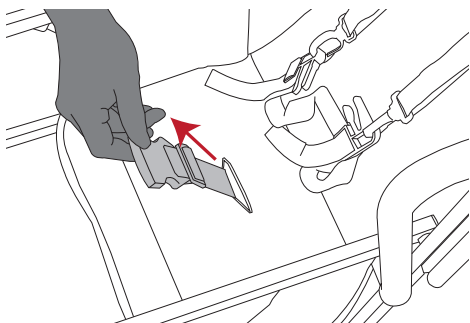

Figure 4.1

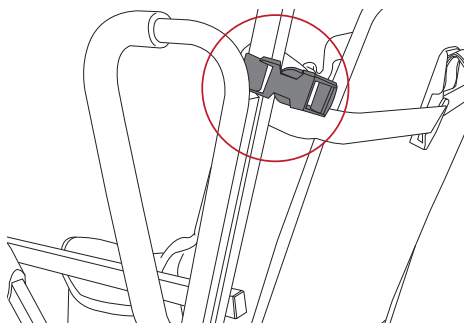

Figure 4.2

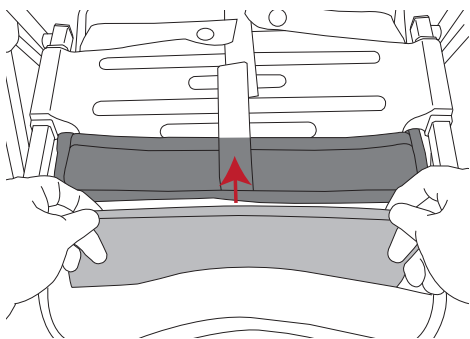

Figure 4.3

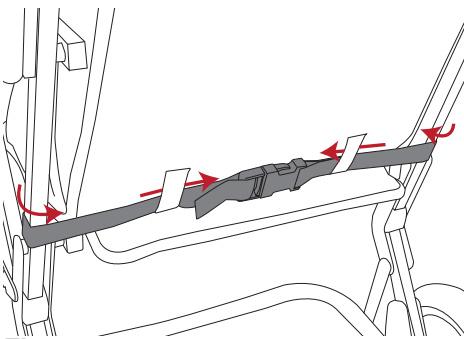

Figure 4.4

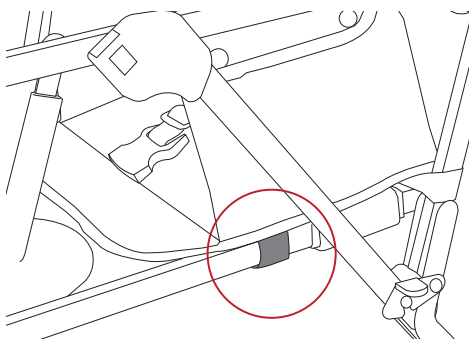

Figure 4.5

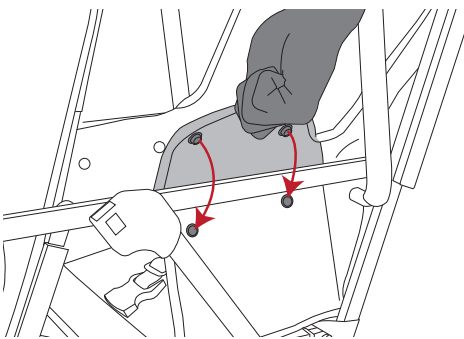

Figure 4.6

5 Seatback Positioning

The seat back can be adjusted to any position from fully upright to reclining. This seat should only be used for a child that is at least 6 months old.

- To recline the seat, release the adjustment lock tab from its locked position by pulling it away from the seat back. Continue to pull this lock tab downward to adjust the seat back to the desired position, then re-engage the lock tab.

See Figure 5.1.

- To adjust the seat back to a more upright position, release the adjustment lock tab from its locked position. Then simply pull up on the adjustment strap ring until the seat back is in the desired position and re-engage the lock tab.

See Figure 5.2.

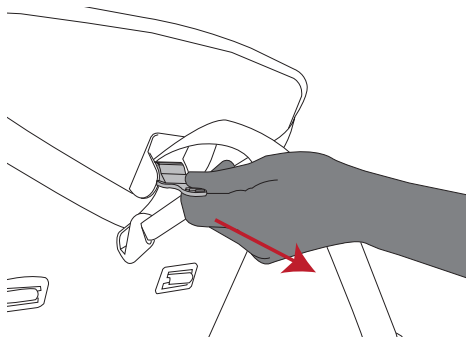

Figure 5.1

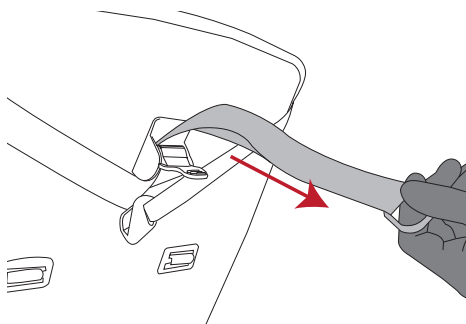

Figure 5.2

WARNING

ALWAYS ensure that the seatback is secured into its position.

Push down on the seatback to be sure it is secure.

NEVER adjust the seatback when the child is in the seat.

6 Securing the Child

- Ensure that both shoulder straps are attached to the waist strap buckles. **See Figure 6.1.**
- Unlatch the waist/shoulder buckle by squeezing the latch releases on both sides of the buckle and removing the male ends of each buckle.
- Carefully place the child in the seat with the shoulder straps over their shoulders and chest. Then place the crotch strap between the child's legs.

NOTE: There are three height adjustment positions for the shoulder harness straps. For a younger child, the shoulder straps should be positioned through the lower sewn-in loops on the seatback. For a young child that is tall, the shoulder straps may be positioned through the upper sewn-in loops on the seatback. For a taller child, use the shoulder straps **WITHOUT** positioning them through these sewn-in loops. To re-position the shoulder straps, unbuckle them from the harness buckle and feed these straps through the sewn-in loops, ensuring that they are not twisted. Re-buckle the shoulder straps onto the harness buckle to secure them.

- Bring the seat belt around the child's waist and insert the male ends of the waist/shoulder buckle into the female buckle. Ensure that they snap into place. **See Figure 6.2.** Tighten the waist belt to be snug around the child's waist.
- Both the shoulder straps and the waist/crotch straps may be adjusted using the sliding buckles on these straps. **See Figures 6.3 and 6.4.**

WARNING

Avoid serious injury from falling or sliding out. Always use the seat belt and harness. This seat is not suitable for children under 6 months.

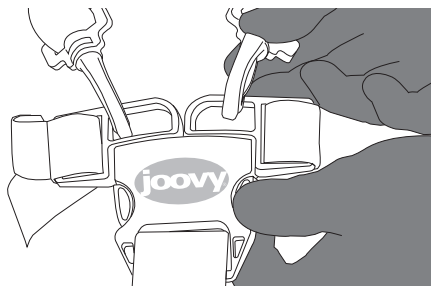

Figure 6.1

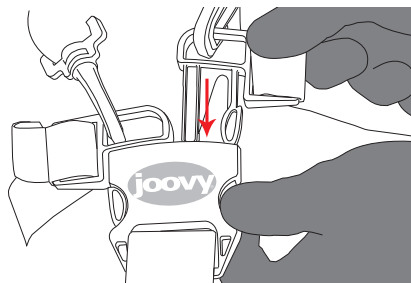

Figure 6.2

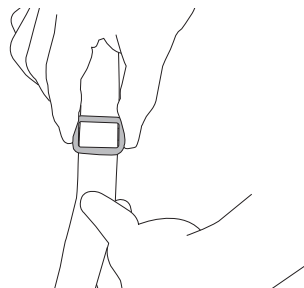

Figure 6.3

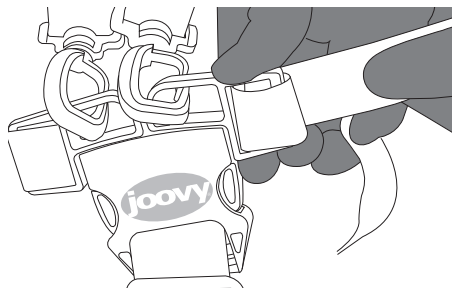

Figure 6.4

7 Removing the Caboose Too Rear Seat

- Unsnap the waist and shoulder straps from the crotch strap. Leave the crotch strap in place to use with the stroller rear bench seat.
- Unwrap the left and right armrests of the Caboose Too rear seat from around the upper horizontal frame (on each side). Unsnap both snaps on each side. **See Figure 7.1.**
- Near the front sides of the Caboose Too rear seat are 2 Velcro® straps (one on each side). Pull these straps apart. Repeat on the other side. **See Figure 7.2.**
- Locate the 2 straps on the upper rear of the Caboose Too rear seat (one on each side). Unsnap them from around the handle bar above the rear handles. **See Figure 7.3.**
- Locate the long straps on the lower rear of the Caboose Too rear seat. Unsnap the straps and unwrap each strap from around the outside of the stroller handle bar by feeding them through the loops on the back of the seat. **See Figure 7.4.**

See Figure 7.4.

- Push the rear seat crotch strap (with the buckle) through the slit in the Caboose Too rear seat (See **Figure 7.5**) and pull the Caboose Too Seat off of the rear bench.

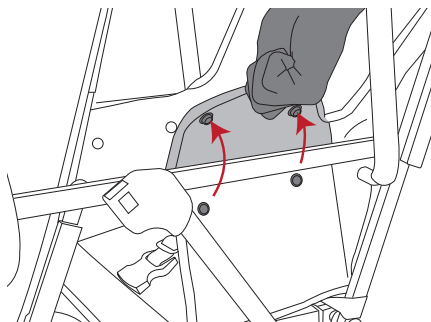

Figure 7.1

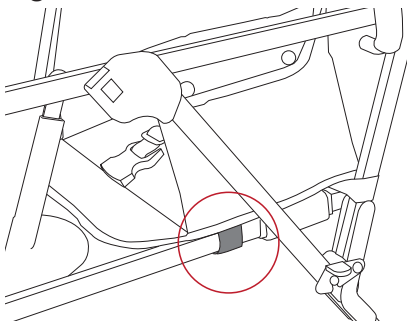

Figure 7.2

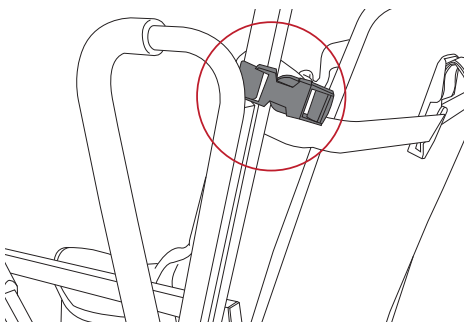

Figure 7.3

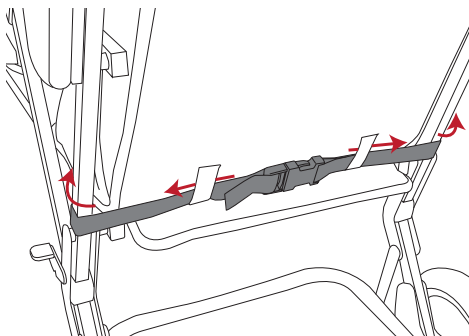

Figure 7.4

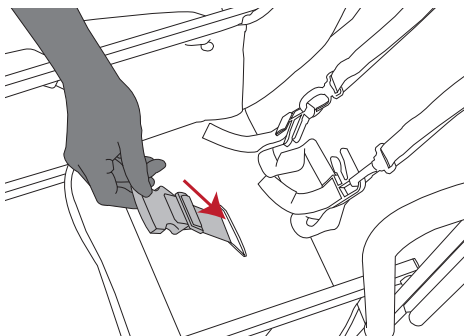

Figure 7.5

8 Installing the Rear Bench Seat Waist Strap

(Caboose and Caboose Ultralight Only)

- To install the rear bench waist strap, locate one end of the waist strap where it has a metal D-ring at the end.
- Wrap the strap around the front seat rear tube. Slide the strap through the small opening of the metal D-ring and pull the strap to secure it to the tube. Repeat for the other end of the strap.

See Figure 8.1.

- Insert the female buckle ends of the waist strap into the male buckle end of the crotch strap.

See Figure 8.2.

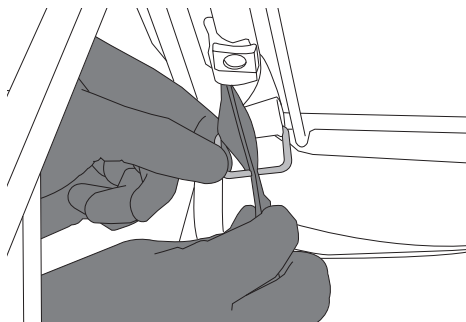

Figure 8.1

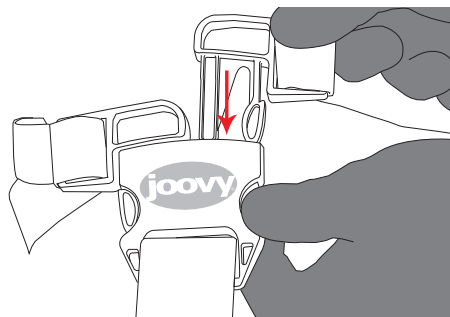

Figure 8.2

9 Installing the Rear Bench Seat Waist Strap (Big Caboose Only)

- To install the rear bench waist strap, locate one end of the waist strap where it has a small hole and insert a screw with a black square washer.

See Figure 9.1.

- Insert the screw into one of the holes on the lower vertical frame bars and using a Phillips head screwdriver screw in the screw all the way. Repeat for the other end of the strap.

See Figure 9.2.

- Insert the female buckle ends of the waist strap into the male buckle end of the crotch strap.

See Figure 9.3.

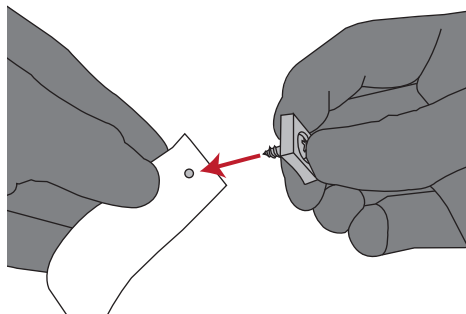

Figure 9.1

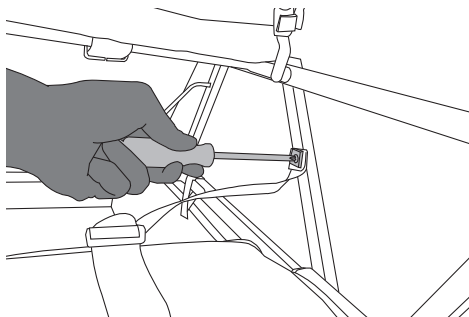

Figure 9.2

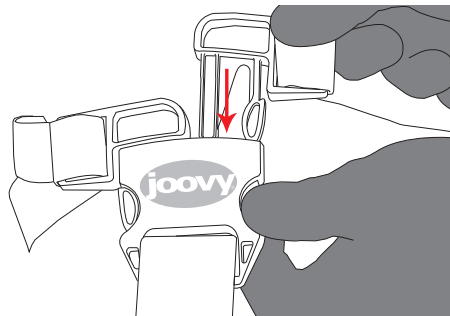

Figure 9.3

Maintenance

All of the fittings, snaps, locks, and other hardware and plastic parts on the seat should be inspected periodically to ensure that they are secured properly and not damaged or malfunctioning. The seat belts and safety harnesses, as well as all other straps and fabric items and their stitching should also be inspected periodically to ensure that they are secured properly and not loose, torn or otherwise damaged. All moving parts should also be checked periodically to ensure they are operating properly.

Any missing, broken, or worn components should be replaced immediately, and the seat should not be used until they are replaced. Only original manufacturer's components should be used. If needed, please contact Joovy at our toll-free phone number.

Fabric fading may occur if the stroller is left in direct sunlight for long periods of time. When not in use, store the stroller out of direct sun.

Cleaning

The fabric material on this seat can be cleaned using mild household soap or detergent and warm water on a sponge or clean cloth. Always allow the fabric to completely air dry before using the stroller.

SATISFACTION GUARANTEED

We want you to be completely satisfied with your purchase of this product. Should you experience any difficulty in assembling or using this product, or if you have any questions, please contact our Customer Service Department at (877) 456-5049 between the hours of 8:30 am and 5:00 pm Central Time.

Please log onto www.joovy.com to register your new Joovy product.

The screenshot shows the Joovy website homepage. At the top, there is a navigation bar with links for "home", "products", "blog", "customer service", and "contact". Below the navigation bar, there is a large banner for "Introducing the Room" Ultra lightweight, roomy and super soft. The banner features a woman sitting on a stroller and a stroller itself. To the right of the banner is a "MORE" button. Below the banner, there is a "Customer Service" section with a phone number (877-456-5049) and an email link. To the right of the customer service section is a "We are Joovy..." section with a description of the company and its products. Below the customer service section is a "Featured: CocoonX2 Stroller" section with a photo of the stroller and a "learn more" button. To the right of the featured stroller section is a "Sign Up For Specials!" section with a form for first name, last name, and email address, and a "submit" button.

Look for these other Joovy products



Spoon™

**Caboose™
Ultralight**



Loo™



Joovy • 2919 Canton Street • Dallas, TX 75226 • (877) 456-5049 • Fax: (214) 761-1774
Email: customerservice@joovy.com • Web Site: www.joovy.com

©Joovy 2012 • Document Version 091312