

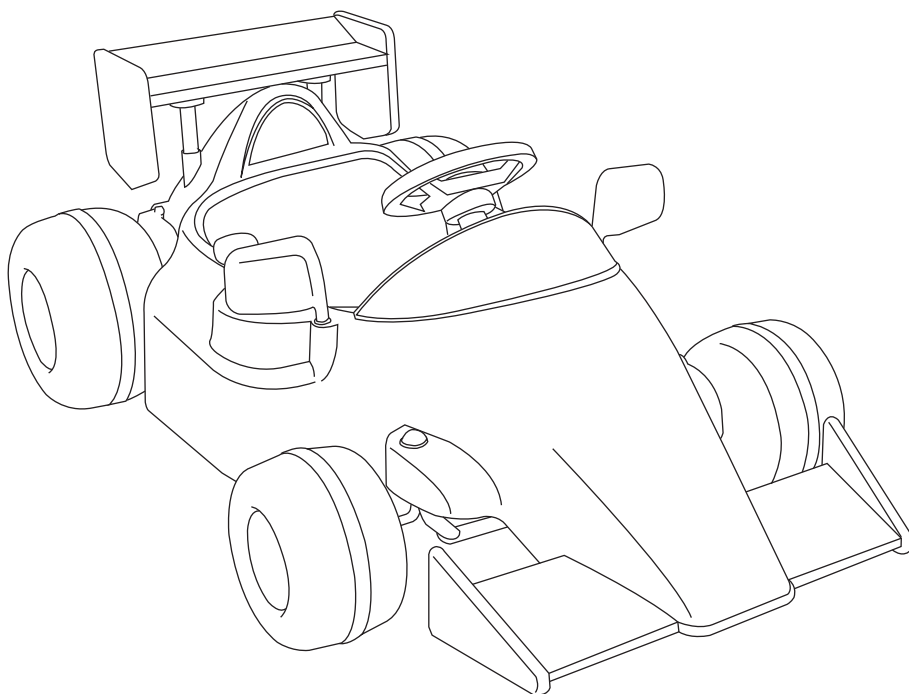

Racecar Instruction Manual

0008X Series

Patent No. VAu 210 203





WARNINGS

Please read this instruction manual completely before using this product. Keep these instructions for future reference.

TO AVOID SERIOUS INJURY

- Continuous adult supervision is required.
- Never use near motor vehicles.
- Never use near streets, swimming pools or other bodies of water, hills, steps, or sloped driveways.
- Rider must always wear shoes when using this product.
- Allow only one occupant.
- Use only on concrete, black top, tile/wood/marble floors.
- Only use batteries specified by the manufacturer.
- Only use the charger specified by the manufacturer.
- Minimum age of rider shall be 3 years.
- Maximum age of rider shall be 5 years.
- Maximum weight of rider shall be 80 lbs.
- CHOKING HAZARD - Small parts. Not for children under 3 years.
- Batteries may be very warm when charging.
- Always follow battery charging instructions.
- DO NOT exceed maximum charging time of 20 hours as this may damage the batteries and the charger.
- Keep children away from product while batteries are charging.

IMPORTANT NOTE

**Batteries must be charged BEFORE operating this product for the first time.
See page 9 for battery charging instructions.**

Please do not return this product to the store

If you experience any difficulty with the assembly or use of this product, or if you have a question regarding these instructions, please contact our Customer Service Department at (877) 456-5049 between the hours of 8:30 am and 5:00 pm Central Time.

Please note: Styles and colors may vary.

Assembling and Using your Vehicle



To ensure safe operation of your vehicle, please follow these instructions carefully.

Unpacking the Product

- Carefully remove all parts from the box and plastic bag.
 - Identify the parts (vehicle [not shown], carpet, front wheels (2), rear wheels (2), steering bar, steering wheel, back spoiler, spoiler bars (2), windshield, front wheel hub caps (2), rear wheel hub caps (2), spare fuses (2), left and right side mirrors, battery charger, rear wheel axle, tool, white caps (4), wide head screw, round head screw and nut, plastic inserts (4), plastic anchors (4), small washer (2), and documents [not shown]) with the pictures in Figure 1.
- NOTE: Extra screws and nuts may be included.
- Discard all packaging materials properly.
 - Remove the plastic coverings from any areas of the product and discard also.
 - DO NOT allow children to play with any packaging materials.

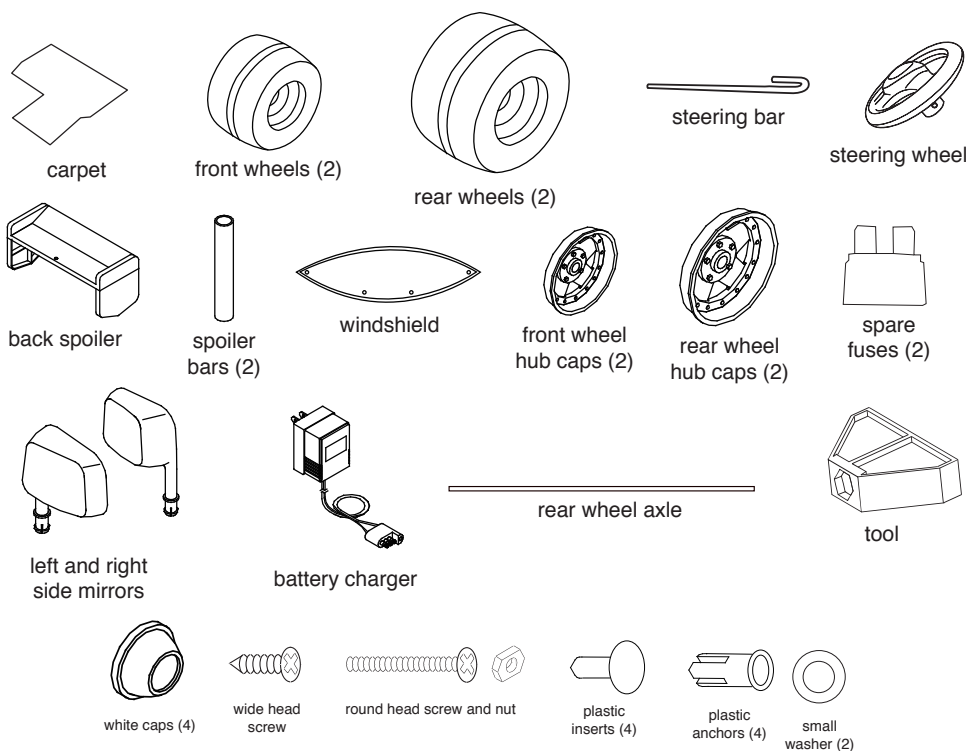

Figure 1



WARNING

Adult assembly is required.

Tools Required (not included): Phillips Head Screwdriver and Hammer.

This package contains small parts which can be choking hazards.

Some parts may have sharp edges and sharp points.

Keep all small parts out of the reach of children at all times.

Installing the Steering Wheel

NOTE: Installation is easier with a second person to hold the steering bar.

- Lift the front of the vehicle up and slide the straight end of the steering bar through the hole in the vehicle body. Also insert the curved end of the steering bar into the slot in the metal front axle assembly. Slide the bar all the way until the smaller diameter end of the curved end is all the way into the front axle assembly hole. See Figure 2.

NOTE: It is easier to have a second person hold the steering bar in place while you attach the steering wheel.

- Place the steering wheel on the steering bar so that the holes on the steering wheel line up with the holes in the steering bar.
- Insert the round head screw through the hole in the steering wheel so that it comes out the other side. Attach the nut to the screw and tighten using the tool provided and a Philips head screwdriver. See Figure 3.
- Pull and turn the steering wheel to ensure it is secure.

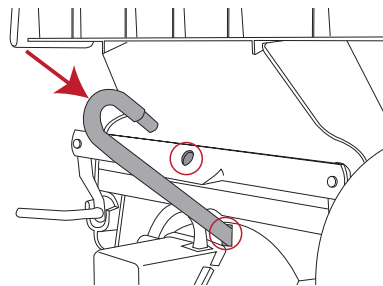

Figure 2

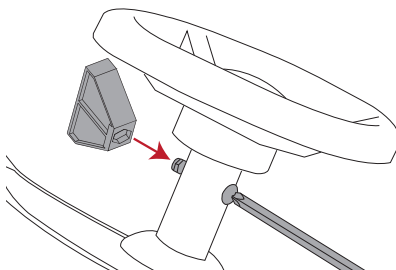

Figure 3

Installing the Front Wheels

- Slide a small washer onto the front axle. See Figure 4.
- Slide a front wheel over the front axle so that the side with the gear shape is facing the vehicle. See Figure 5.
- Slide a front wheel hub cap over front axle and secure wheel by tapping a white cap on the front axle with a hammer. See Figure 6.
- Repeat these steps for the other front wheel.
- Pull on each wheel to ensure that it is secure.

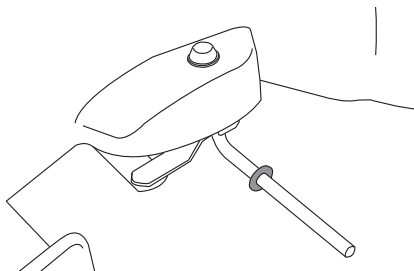

Figure 4

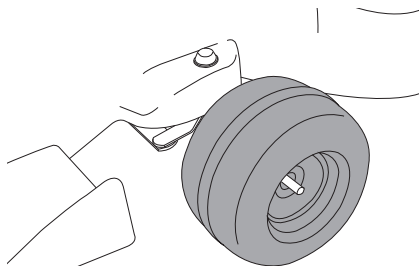

Figure 5

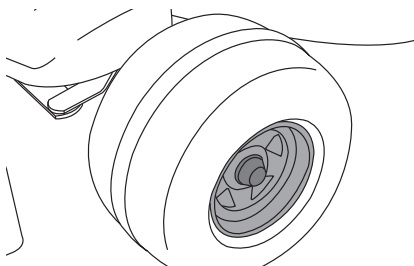

Figure 6

Installing the Rear Wheels

- Insert one end of the rear wheel axle through a rear axle hole in the vehicle. See Figure 7.
- Push axle until the other end comes out the other side of the vehicle.
- Place a rear wheel over the rear wheel axle so that the gear shape side of the wheel is facing the vehicle. Push the wheel until it slides into the gear shaped hole of the vehicle. See Figure 8.
- Slide a rear wheel hub cap onto the rear wheel axle and secure wheel by tapping a white cap on the rear axle with a hammer. See Figure 9.
- Repeat these steps for the other rear wheel.
- Pull on each wheel to ensure that it is secure.

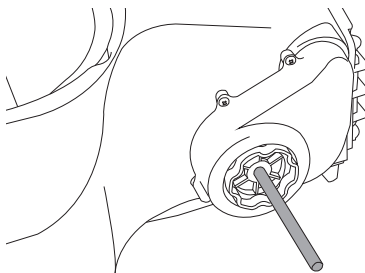

Figure 7

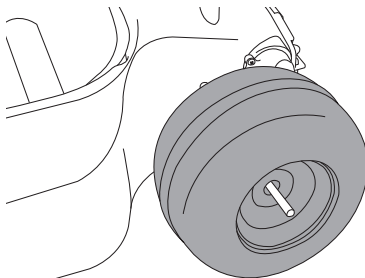

Figure 8

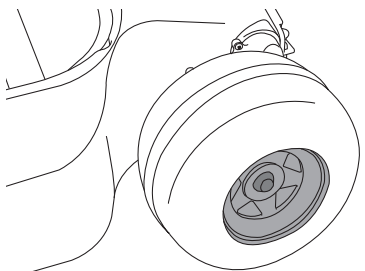

Figure 9

Installing the Windshield

- Place the windshield on the dashboard, make sure the four holes along the bottom of the windshield line up with the four holes on top of the dashboard. See Figure 10.
- To secure the windshield, place a plastic anchor into each of the four holes. Then place a plastic insert into the anchors to secure the windshield in place. Push down on the insert as far as it will go. See Figure 11.
- Pull up on the windshield to ensure that it is secure.

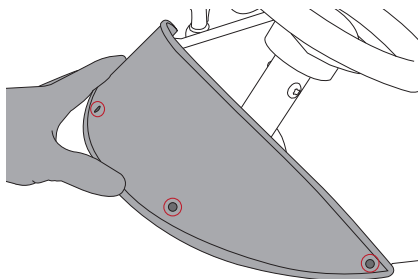

Figure 10

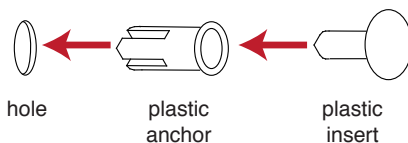

Figure 11

Installing the Back Spoiler

- Insert a spoiler bar into each hole located on the bottom side of the spoiler. See Figure 12.
- Insert the back spoiler into the holes on the rear of the vehicle. See Figure 13.
- Screw the wide head screw into the hole. See Figure 14.
- Pull up on the back spoiler to ensure that it is secure.

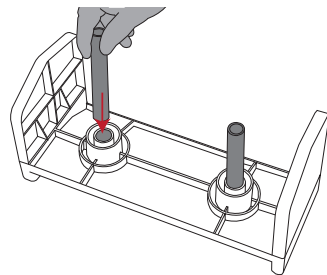

Figure 12

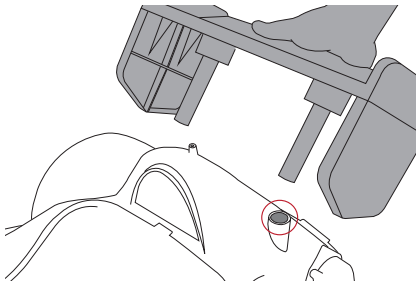

Figure 13

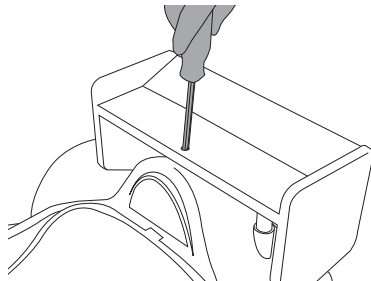

Figure 14

Installing the Side Mirrors

- Insert a side mirror (with the mirror facing the rear of the vehicle) into each of the holes found on the sides of the vehicle. See Figure 15.
- Pull up on both mirrors to ensure that they are secure.

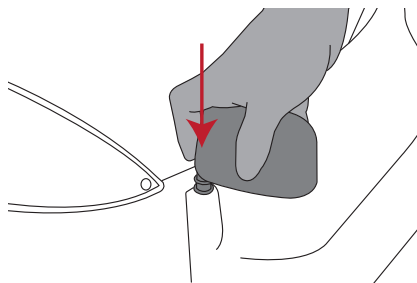

Figure 15

WARNINGS

PREVENT FIRE

- Batteries can fall out and injure a child if vehicle tips over.
- Always use battery retainer.
- Never modify the electrical system.
- Alterations could cause a fire resulting in serious injury and could also damage the electrical system.
- Use of the wrong type of batteries or charger could cause a fire or explosion resulting in serious injury.
- Use of non-Joovy components in Joovy vehicles could cause overheating, fire or explosion.
- The batteries must be handled by adults only. The batteries are heavy and contain sulfuric acid. Dropping the batteries could result in serious injury.
- Batteries charging must be done by adults only. A child could be injured by the electricity involved in charging the batteries.
- Read the safety instructions on the batteries.
- Examine the batteries, charger and their connectors for excessive wear or damage each time you charge the batteries. If damage or excessive wear is detected, do not use the charger or the batteries until you have replaced the worn or damaged part.
- DO NOT store batteries where the temperature may reach 104° F (40° C).

CONTACT JOOVY AT (877)456-5049 FOR REPLACEMENT PARTS.

- Batteries replacement part number: BATRC (6 volt, 10 Amp hour)
- Charger replacement part number: CHARC
- Fuse replacement part number: FUSE30

Charging and Connecting the Batteries

IMPORTANT NOTE: The batteries must be charged **BEFORE** operating this product for the first time. Charge batteries initially for 8 to 10 hours **ONLY**.

- Rotate the seat forward. See Figure 16.
- Find the battery wires and connect the battery charger plug to the battery wire plug. Push the plugs together securely. See Figure 17. Plug charger into a standard 120 volt outlet.
- After initial charging is complete, disconnect the charger plug from the battery wire plug and connect the vehicle main wire plug to the battery wire plug.
- Push the seat back down into place.
- To recharge the batteries, repeat the steps above. After 8 to 10 hours, disconnect the charger plug and connect the vehicle main wire plug to the battery wire plug.
- After any charging cycle is complete, unplug the charger from the outlet and store it out of children's reach.
- Charge the batteries fully after use to ensure the longest battery life.
- When storing the vehicle, fully charge batteries, then disconnect the charger plug (or vehicle main wire plug) from the battery wire plug to prevent drainage. Connect the charger plug from the battery wire plug to charge at least once a month.

IMPORTANT NOTE: The battery life depends on environment and usage. Typically, batteries diminish or fail after about 300 charges. If your batteries fail to take a charge, or the charge is very diminished, then you will need to replace the batteries. Joovy warrants the batteries for 6 months from purchase.

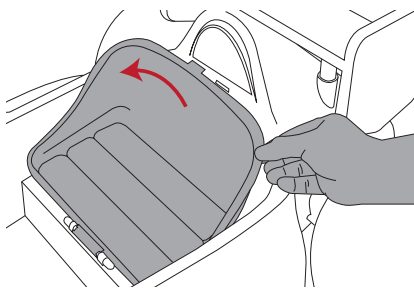

Figure 16

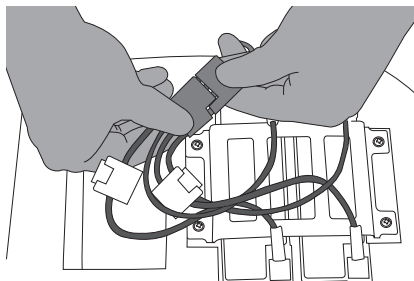

Figure 17

WARNINGS

NEVER exceed 20 hours of charging or recharging.

Use the charger in dry locations only.

ALWAYS unplug charger from electrical outlet when charging is complete.

Keep children away from product while charging.

Operating Instructions

For this section refer to Figure 18.

WARNING

The key does NOT turn the car off and on. Once the battery is connected, the car will ALWAYS be on until the battery is disconnected.

- Use the key to turn the sound on and off.
- Use the switch to set the vehicle to FORWARD or REVERSE motion. To switch the vehicle to FORWARD motion make sure that the switch is on “F”. To switch the vehicle to REVERSE motion make sure the switch is on “R”.
- The gear shift lever is used to switch from fast mode to slow mode. Push the lever UP to operate in fast mode (both batteries in use). Push the lever DOWN to operate in slow mode (one battery in use).
- To make the vehicle move, push down on the accelerator pedal (the pedal on the right). To slow down or stop the vehicle, release the accelerator pedal.
- To steer the vehicle, turn the steering wheel right to go right and left to go left.

NOTE: This vehicle is installed with an automatic thermal shutdown system. When the vehicle is overloaded, the power will cut off automatically for 15 to 20 seconds and then will reconnect.

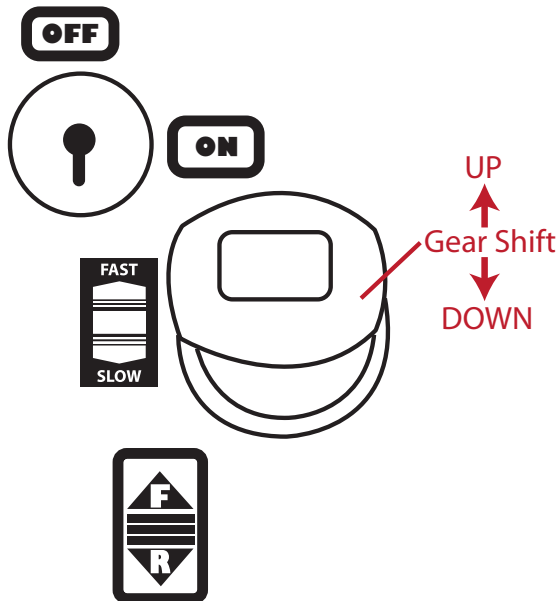

Figure 18

WARNING

**This vehicle does NOT have a braking system.
Always supervise your child while in this vehicle.**

TROUBLE SHOOTING

If the vehicle does not operate:

- 1) Check battery fuses, located on the main battery wire. If the fuse is blown, replace it with the spare 30 Amp automotive flat blade fuses that came packaged with the parts. See Figure 19.
- 3) Check every connection on battery wire.
- 4) If vehicle is running slow, recharge the battery.
- 5) If battery cannot be charged, check fuse and adapter connections.
- 6) If problem persists, please contact customer service at (877) 456-5049.

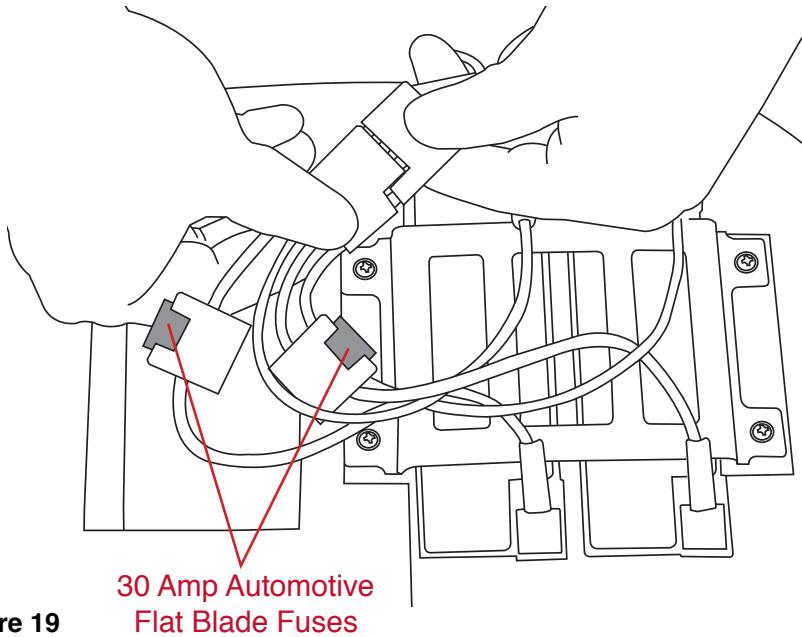

Figure 19

**30 Amp Automotive
Flat Blade Fuses**

Maintenance

All of the fittings, snaps, locks, rivets, and other hardware and plastic parts on the vehicle should be inspected periodically to ensure that they are secured properly and not damaged or malfunctioning. The screws and nuts should also be inspected periodically to ensure that they are secured properly and not loose or otherwise damaged. All moving parts, such as wheels and hinges should also be checked periodically to ensure they are operating properly.

Any missing, broken, or worn components should be replaced immediately, and the vehicle should not be used until they are replaced. Only original manufacturer's components should be used. If needed, please contact Joovy at our toll-free phone number (877) 456-5049.

Color fading may occur if the vehicle is left in direct sunlight for long periods of time. When not in use, store the vehicle out of direct sunlight.

Cleaning

The plastic material on this vehicle can be cleaned using mild household soap and warm water on a sponge or clean cloth. Always allow the plastic to completely air dry before using the vehicle.

The frame and wheels should always be kept clean and free of dirt and foreign matter, especially after operating the vehicle in rain, snow, or other harsh environments. Use a sponge or cloth dampened with warm water and a mild household soap to clean the wheels after such use.

SATISFACTION GUARANTEED

We want you to be completely satisfied with your purchase of this product. Should you experience any difficulty in assembling or using this product, or if you have any questions, please contact our Customer Service Department at (877) 456-5049 between the hours of 8:30 am and 5:00 pm Central Time.

Please log onto www.joovy.com to register your new Joovy product.

[Shopping Cart \(0 Items\)](#) [Login](#) [Account](#) [Store Locator](#) [Customer Service](#) [877-456-5049](#) [Go](#)

joovy [eat](#) [play](#) [sleep](#) [walk](#) [stroll](#) [run](#) [ride](#) [potty](#) [carry](#) [parts](#) [blog](#) [contact](#)



BicycocoBMX Balance Bikes

[MORE](#)

latest news

11/7/2012 - "1 Voted" Joovy Tuesday Giveaway

The winner of our "1 Voted" Joovy Tuesday Giveaway has been chosen randomly by Rafflecopter. The winner of the \$100 to spend at Joovy is Manda. ...[Read more](#)

featured products



Caboose Too Rear Seats



theBabaSling



Walker Meets Highchair

The Spoon walker combines these two essential products into one to provide the perfect balance of eating, playing and learning to walk!

[Shop Now](#)

TheBabaSling by Joovy

As advocates for "baby wearing" we believe theBabaSling is the most amazingly versatile, easy to use sling on the market today.

[Shop Now](#)

Caboose Too Seat adds Extra Seat!

What could be better than the Caboose and Caboose Ultralight? How about an extra full size seat? That's right, now the Caboose and Caboose Ultralight...

[Shop Now](#)







Customer Service

Joovy is BIG ideas from a small company we answer our phones, why not call us?

877-456-5049 or [email us](#)



Cocoon™

Room™



foocot™



Groove™

Bicycoo™ BMX



Bicycoo™





Tricycoo™

ergo Caboose™



Caboose™ Ultralight



Joovy • 2919 Canton Street • Dallas, TX 75226 • (877) 456-5049 • Fax: (214) 761-1774
Email: customerservice@joovy.com • Web Site: www.joovy.com

©Joovy 2013 • Document Version 011613